

ELEVATION

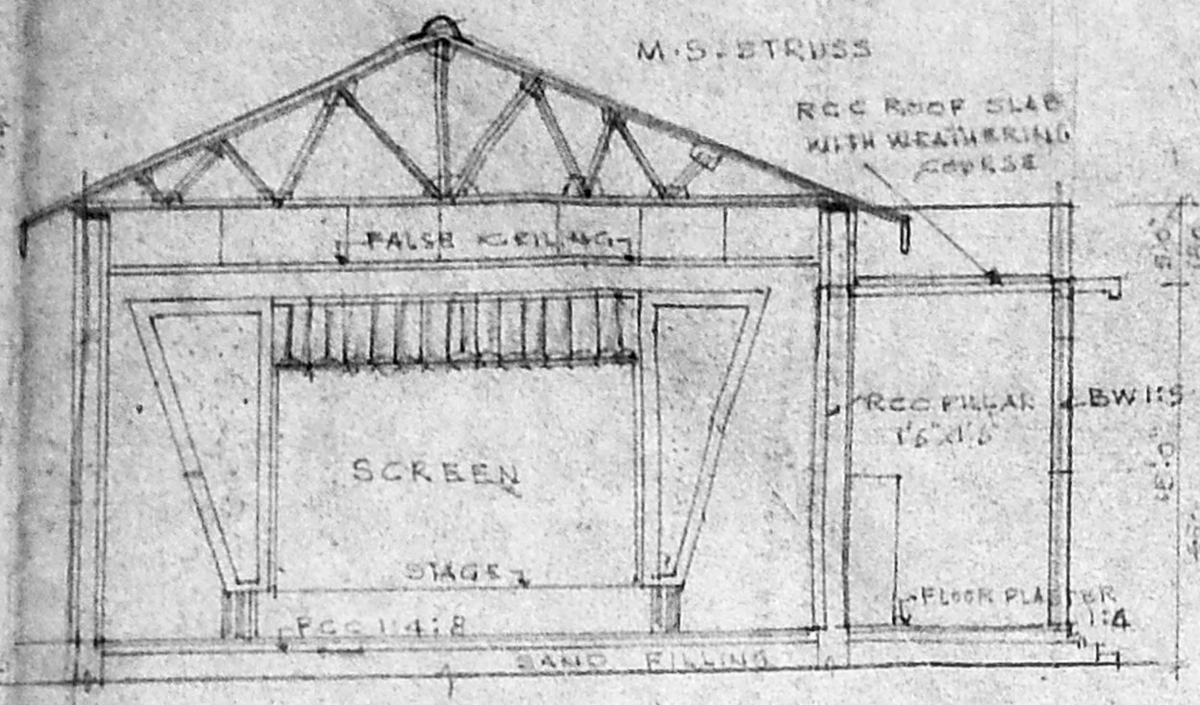

SECTION ON A-A

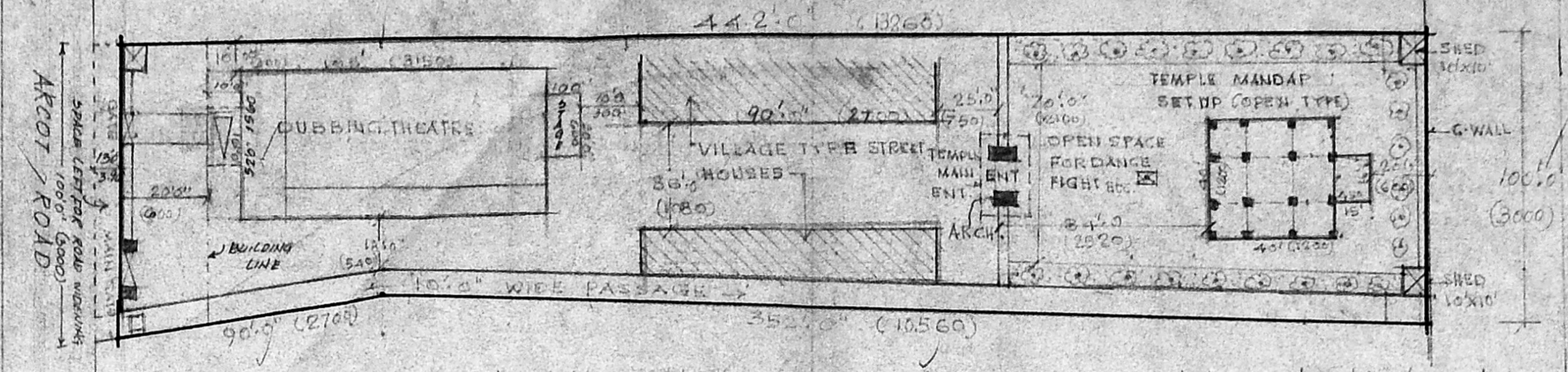

Location plan of dubbing theatre and outdoor shooting sets

Planning Permit No. C/24589/86/S7
 SCALE: 1/4" = 1'-0"

APPROVED
 SUBJECT TO THE CONDITIONS IN THIS OFFICE LETTER.

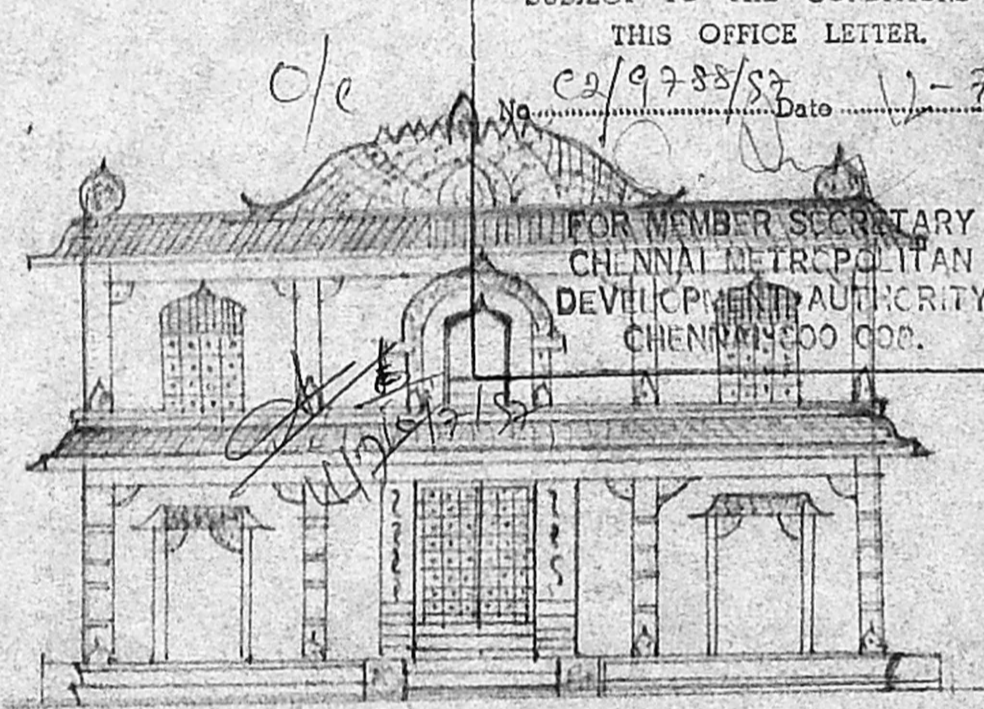

ELEVATION

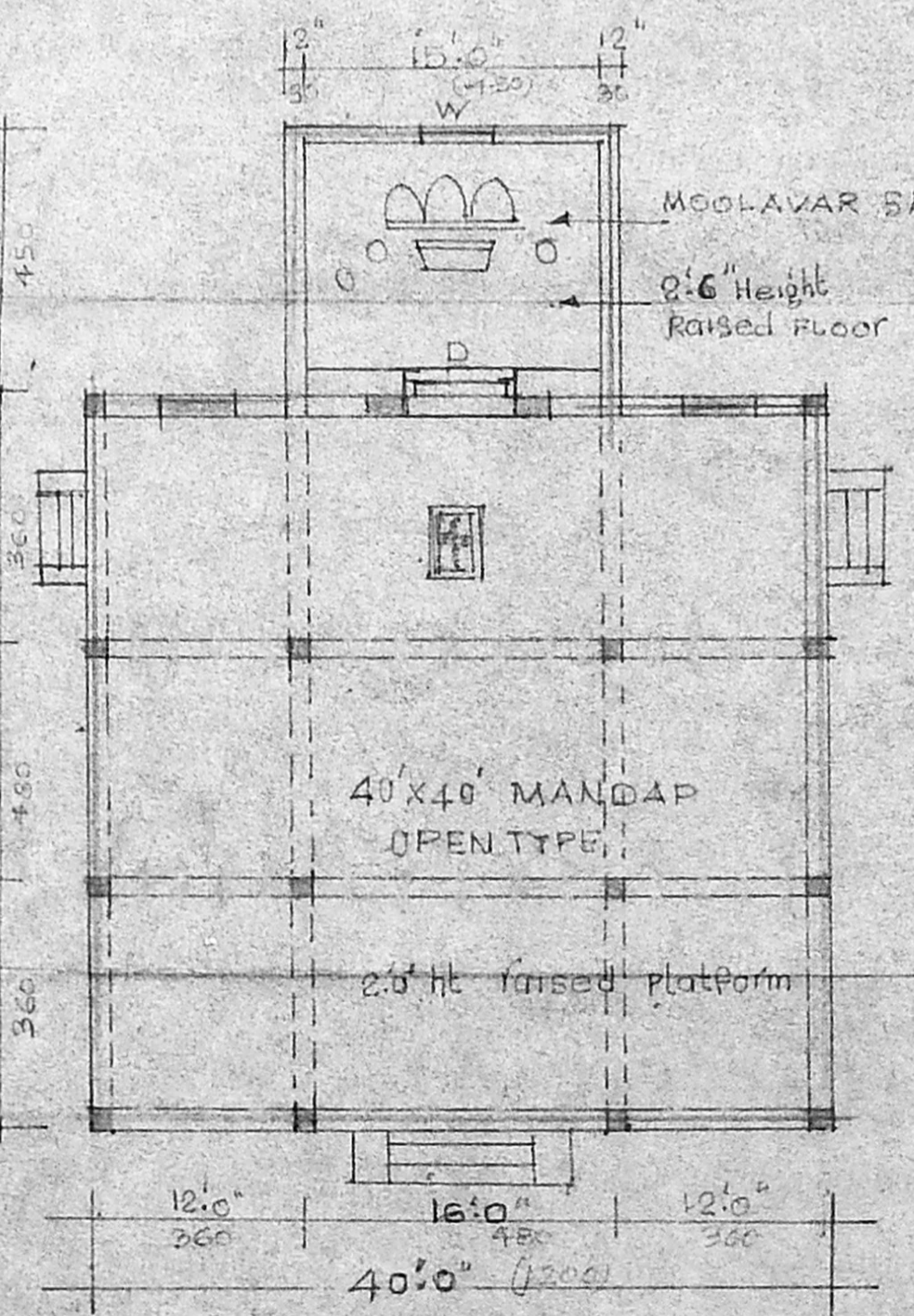

Plan of temple set

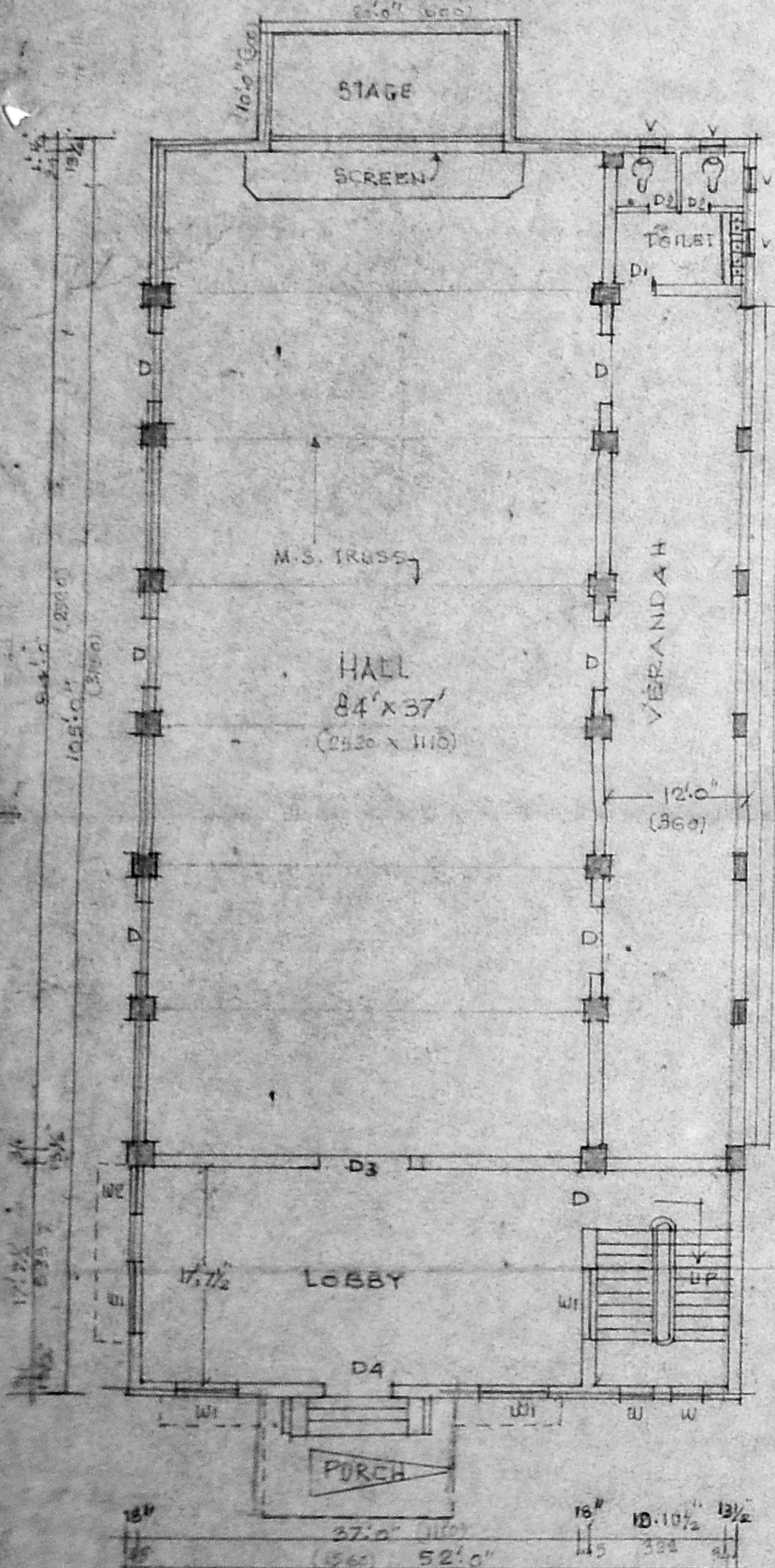

Ground floor plan of dubbing theatre



First floor Plan

SCALE: 1 INCH = 10 FEET

R. Mohan Rao, D.C.E.
 LICENSED SURVEYOR
 Corporation of Madras
 15, Madley Road,
 MADRAS - 600 017

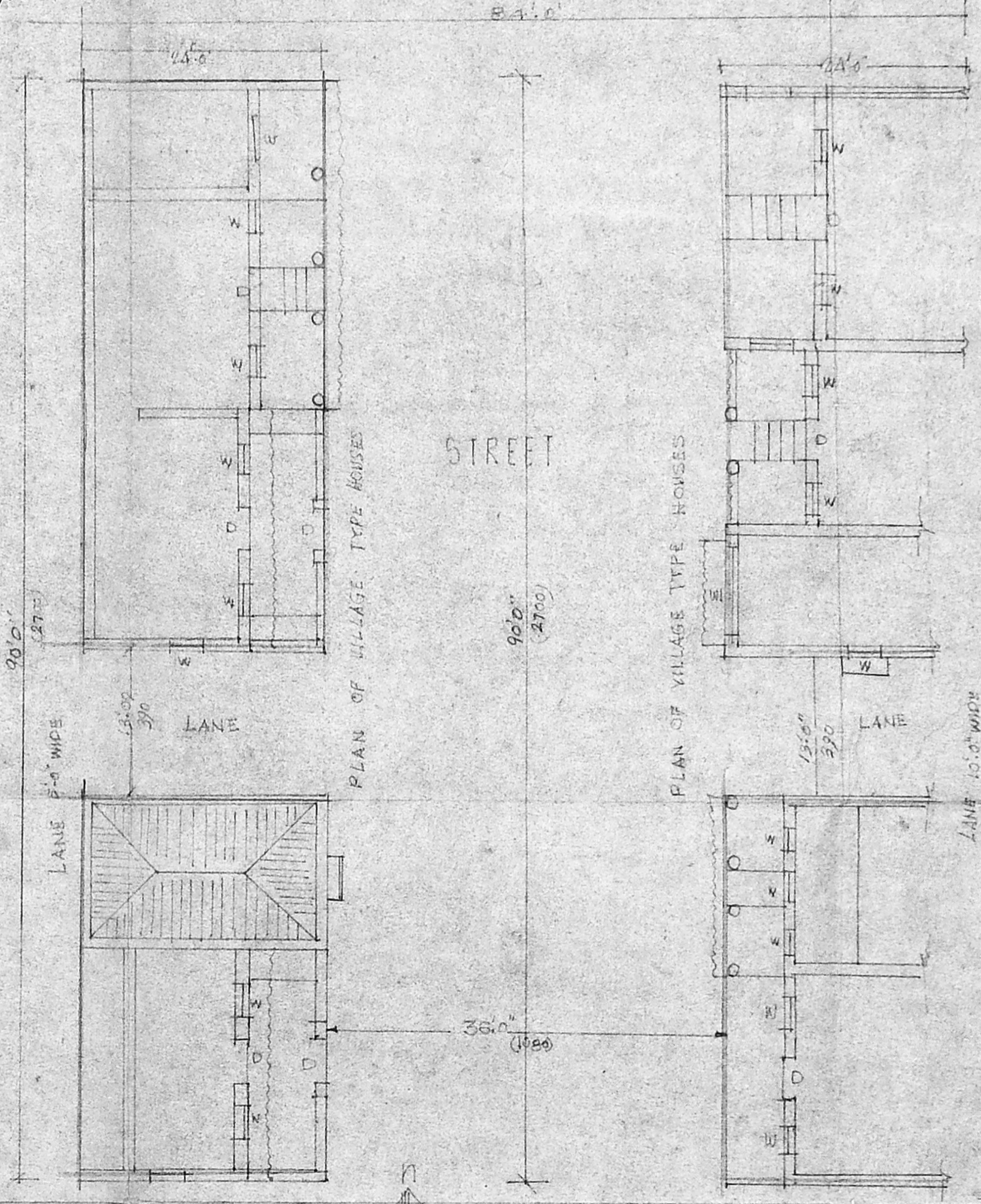

PLAN AND ELEVATION
 Village type houses

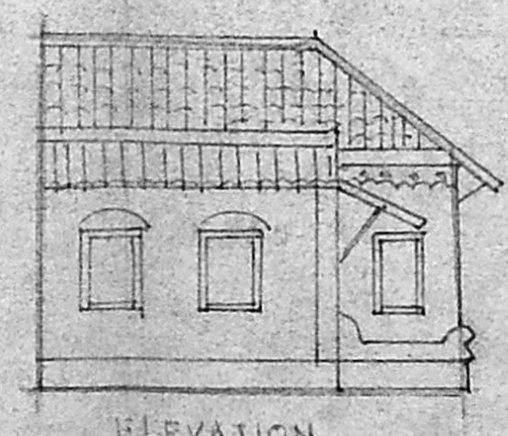

ELEVATION

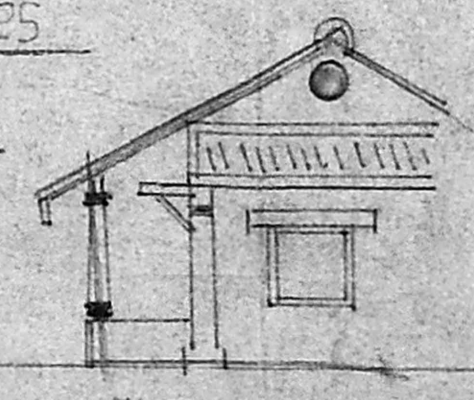

ELEVATION

SCALE: 1 inch = 10'0"

Details of Joineries

D DOOR	4' x 8'	30 x 240
D1	2' x 7'	90 x 210
D2	2' x 7'	75 x 210
D3	5' x 8'	150 x 210
D4	5' x 9'	150 x 225
W WINDOW	2' x 5'	95 x 130
W1	3' x 5'	150 x 130
W2	4' x 5'	170 x 130

For SRI VITTAL COMBINES
M. V. Radhakrishnan Acharya
 Partner

Plinth area:

Dubbing theatre:		
LF	5660 sqft	525.83 M ²
PORTICO	160 sqft	14.88 M ²
FF	1033 sqft	95.97 M ²
Temple set:	1885 sqft	174.33 M ²
Village type houses		
8000 sqft		743.92 M ²
open space of dance		546.27 M ²
shed 2 nos		16.58 M ²

PROPOSED PLAN FOR
 M/S VITTAL STUDIOS IN
 S.No. 116 1/2 Soliagramam
 MADRAS

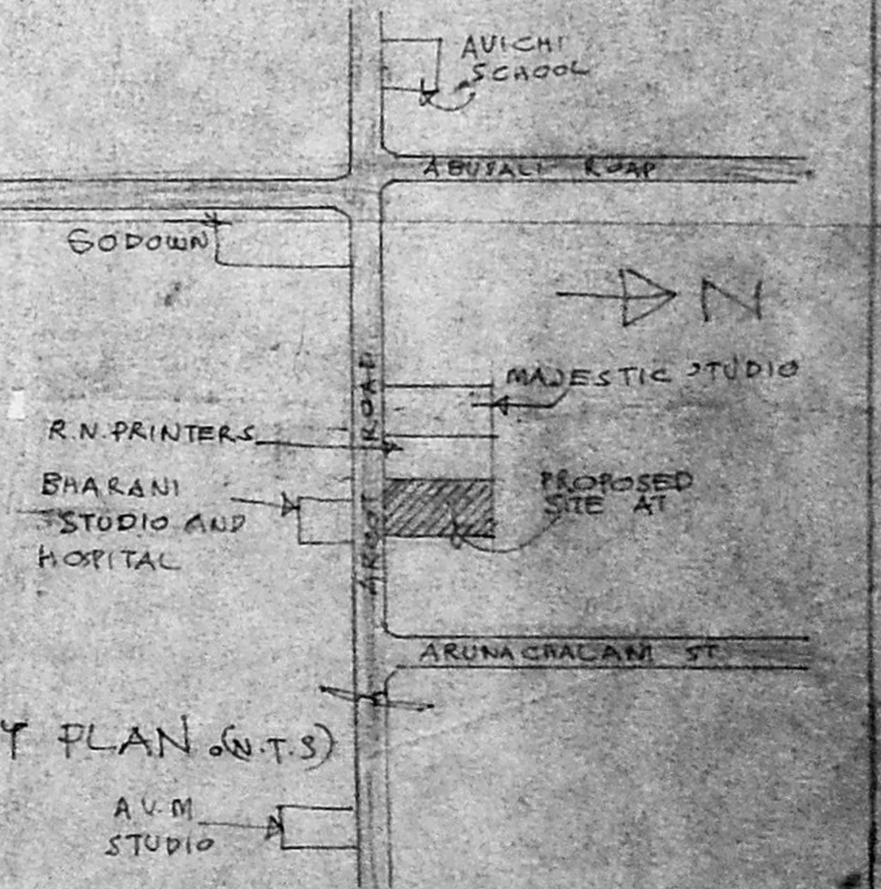

KEY PLAN (SITS)

A.V.M. STUDIO

SCALE: 1 INCH = 10 FEET